

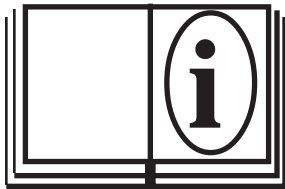



WACHS
AIR TREATMENT MODULE
MODEL 26-407-00



	PIPE & VALVE
	MAINTENANCE MACHINES
Mod. 26-407-00 S/N: <input type="text"/> <input type="text"/> <input type="text"/> <input type="text"/> <input type="text"/> <input type="text"/> <input type="text"/>	
E.H. WACHS COMPANIES 100 Shepard St. Wheeling Il. 60090 Patent Pending	

Part Number: _____

Revision No: 1

Revised:
Apr. '98

WACHS AIR TREATMENT MODULE



Combination service unit

i.e. filter water trap ⑤ pressure ① regulator and oil mist lubricator ⑥ combined in one unit.

Mounting

Can be mounted by means of the already fitted mounting bracket or into a rigid line system.

Installation

The combination service unit should always be installed with the reservoir vertically at the bottom. When connecting, pay attention to the direction of flow which is identified on the top of the unit by an arrow.

Pressure regulator

The pressure gauge ④ can also be screwed into the back of the pressure regulator with a specially-shaped seal. The unused pressure gauge connection should be sealed.

Before initial operation check, the setting knob ⑧ is unlocked ⑨ and the compression spring is fully relaxed by turning to the left. With pressure present on the primary side, the setting knob is now turned to the right until the pressure gauge indicates the desired secondary pressure. Subsequent locking ⑩ of the setting knob holds the pressure setting constant.

Inlet pressure	16 bar	
Nominal pressure	10 bar	
Min.. allowable pressure with drain valve	0.5 bar	2 bar
	manual	fully autom.
Temperature range	0-50°C	
Pore width in filter	40 um	
Minimum flowrate	Graph A	

Filter with water trap Draining the condensate

Semi automatic type The drain valve is open when the pressure is switched off. It closes at an applied pressure of >0.5 bar. Manual draining of the condensate is possible by pushing the button (13) If fully automatic draining is required, use the separate autodrain valve (0821 303018).

Cleaning the sintered bronze filter cartridge

After removing the reservoir, the filter cartridge (11) is removed by unscrewing the baffle plate (12). The filter cartridge should be washed out with benzine or kerosene and should then be blown dry from inside to outside. If heavily fouled, the filter cartridge should be replaced.

7

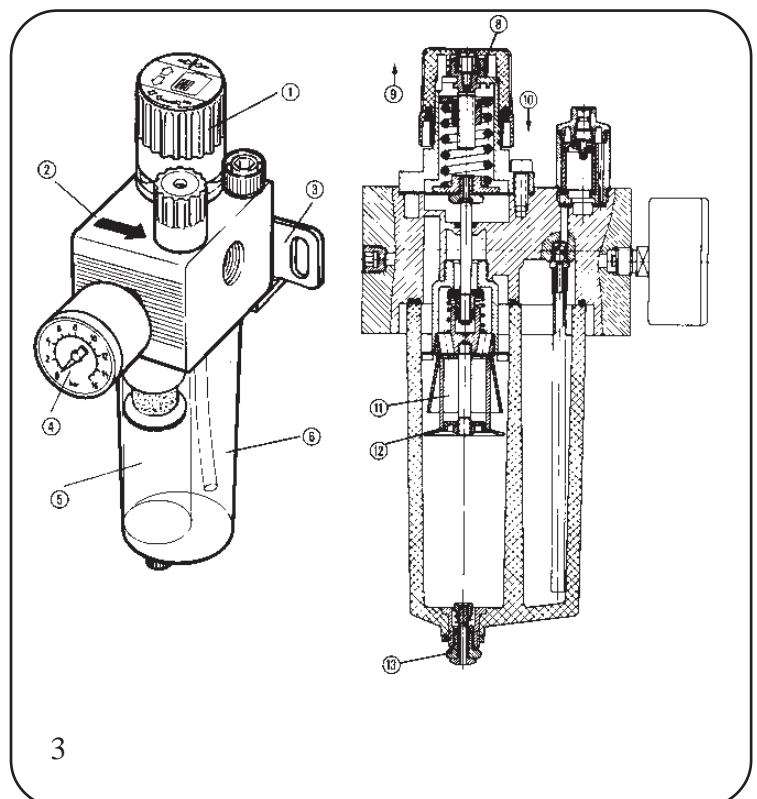
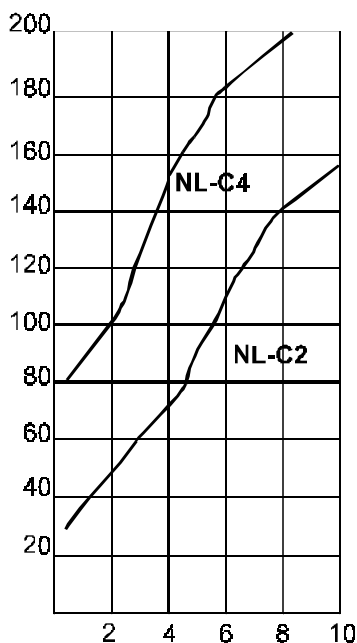

WACHS AIR TREATMENT MODULE

Oil mist lubricator

A minimum flowrate as per graph (7) is required for the operation of the oil mist lubricator.

Topping off with oil is possible during operation by means of an oil spray gun at the opening of the unscrewed oil filter screw (19)

Oil grade:

BOSCH Pneumatic oil Part No.1829990046 - 11
or an oil obtainable from all petroleum companies corresponding to

HL 25 DIN 51524 - ISO VG 32

Setting the number of drops

The quantity of oil added to the compressed air is set by means of the metering screw(17) Turning to the right means fewer drops; turning to the left means more drops. The drops can be seen falling in the sight glass (18).

Guide value for oil metering:

At 1,000 l/min airflow approx. 1-2 drops/mm should fall.

Cleaning the reservoir

At zero pressure, the flange (20) is loosened and the plastic reservoir (with or without protective basket) is removed. To clean the plastic reservoir, use only water, kerosene or benzine. Cleaning agents containing tri, such as benzene, acetone, and all liquids containing softeners, must not be used.out protective basket) is removed. To clean the plastic reservoir, use only water, kerosene or benzine.

Cleaning agents containing tri, such as benzene, acetone, and all liquids containing softeners, must not be used.

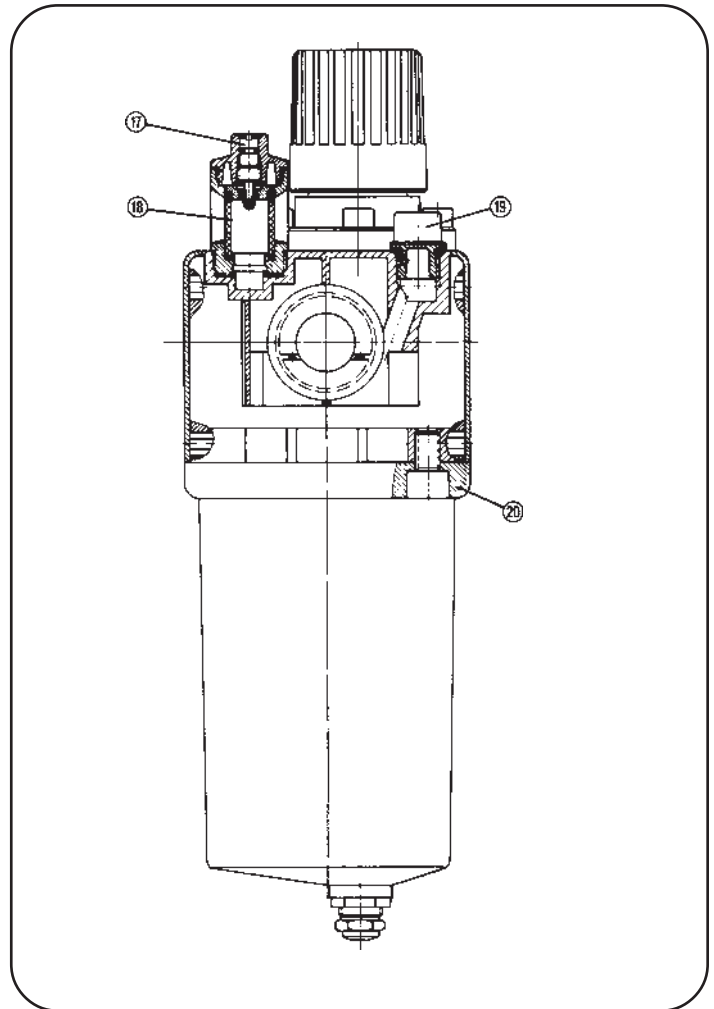

REF	PART NO	QTY	DESCRIPTION	
FASTENERS	26-080-00	1	A.T.M. STAND	
	26-083-00	1	COMBI. BOSCH	
	26-098-00	1	CONTAINER, PINT	
	90-061-07	2	HHCS, 5/16-18 x 3/4	
	90-065-01	2	NUT, HEX 5/16-18	
	90-065-51	2	LKWSHER, 5/16 SPLIT RG	
	90-065-52	2	WASHER, 5/16 FLAT	
				(ALL PARTS LISTED - NOT SHOWN)

WACHS AIR TREATMENT MODULE

ORDERING INFORMATION

To place an order or to get more detailed information on any E.H. Wachs products, call us at:
1-800-323-8185.

ORDERING REPLACEMENT PARTS

Please use parts list provided in manual. Have part description and part number of required replacement part or parts to help expedite order and insure proper parts are being ordered.

REPAIR INFORMATION

Please call E.H. Wachs Company prior to returning any equipment for repair. We will advise you of shipping and handling. Please enclose with equipment to be repaired your name, address, phone number and a brief description of problem or work to be done or estimated.

All repair work done at our plant will be estimated and the customer advised of cost and time required to complete repair.

WARRANTY INFORMATION

Enclosed with the manual is a warranty card. Please fill out the registration card and return to E.H. Wachs. Retain the owners registration record and warranty card for your information.

RETURN GOODS ADDRESS

E.H. Wachs Company
100 Shepard Street
Wheeling, Illinois 60090

Call or Write:

E.H. Wachs Company
P.O. Box A
100 Shepard Street
Wheeling, Illinois 60090

847-537-8800

FAX: 847-520-1147 • 847-520-1168

Toll-Free: 1-800-323-8185

	PIPE & VALVE MAINTENANCE MACHINES
Mod. 26-407-00 S/N: <input type="text"/> <input type="text"/> <input type="text"/> <input type="text"/> <input type="text"/> <input type="text"/>	
E.H. WACHS COMPANIES 100 Shepard St. Wheeling Il. 60090 — Patent Pending —	